

CEILING MOUNT SHOWER ARM

FEATURES

- Solid brass construction
- Ceiling mounted shower arm with adjustable length

COLORS/FINISHES

- #CP Polished Chrome
- #NK Silver Nickel
- #BN Brushed Nickel
- #SF Special Finish (Inquired)

INSTALLATION NOTES

This product is designed for ceiling mount by a licensed professional plumber. Please refer to the installation manual for further instructions.

WARRANTY

- Five-year Limited Warranty for residential use
- One-year Limited Warranty for commercial use

SHIPPING INFORMATION

Package Dimensions
12 13/16" x 3 15/16" x 2 3/4"
Package Weight
N/A lbs

MATERIAL

- Brass



CODES/STANDARDS

- Certifications: IAPMO(cUPC)



DIMENSIONS

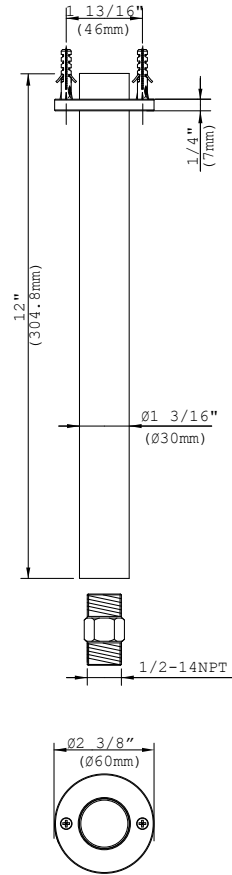

SERVICE PARTS

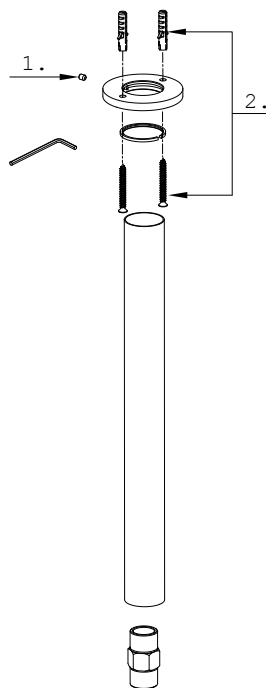

1. Set Screw (A008191)
2. Fixing Kit (A290585)

DATE: 31 DEC 2020