

C O O P E R

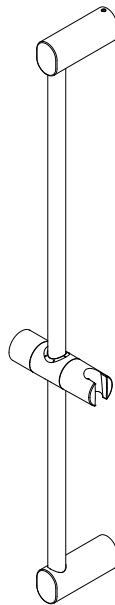

G R A H A M

INSTALLATION INSTRUCTIONS



AIADES SHOWER SLIDE BAR

ADE-17400

DIMENSIONS In Inches & Millimetres

AIADES SHOWER SLIDE BAR

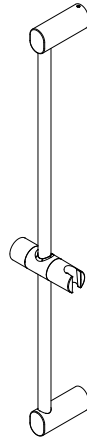

TOP VIEW

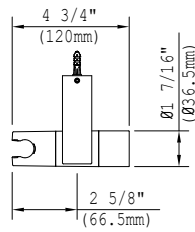

FRONT VIEW

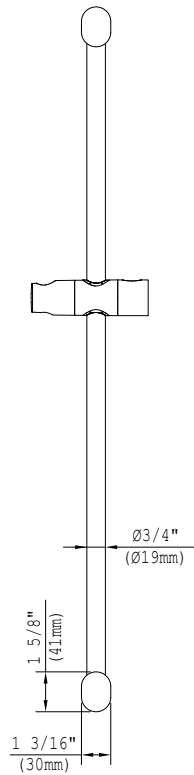

SIDE VIEW

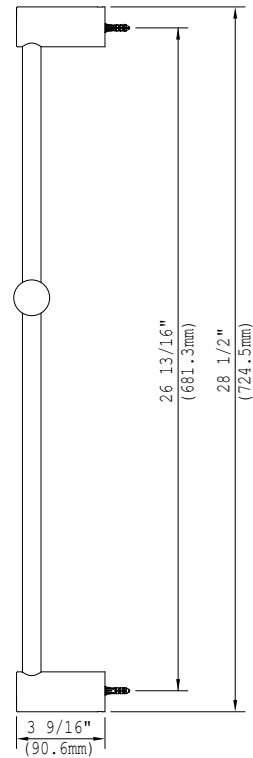

PRODUCT INFORMATION

TOOLS

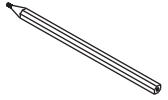

Marking Pencil

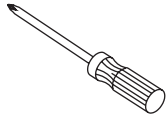

Phillips
Screwdriver



Allen Key



Power Drill

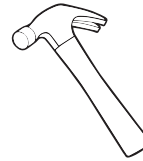

Hammer

MAINTENANCE

- Your new Cooper and Graham product is designed for years of trouble-free performance.
- Keep it looking new by cleaning it periodically with a soft cloth. Avoid abrasive cleaners, wire wool and harsh chemicals as these will dull the finish and void your warranty.

IMPORTANT POINTS

- Overtightening nuts may cause damages.
- When cutting or soldering, use safety glasses to protect your eyes.

INSTALLATION METHOD

STEPS 1 - 3

Cooper and Graham always recommends that plumbing products be installed by a licensed professional.

1.

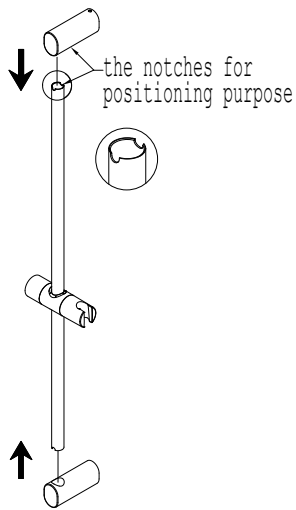

Assemble the slider and posts with the bar. Ensure that the notches on the bar are fitting well with the stoppers inside the posts for positioning purpose.

2.

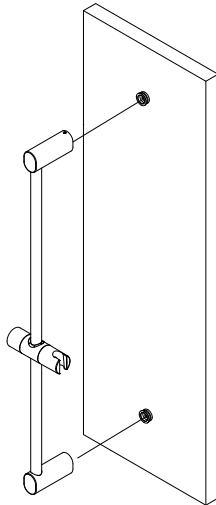

Position the mounting bracket on the wall where required. Mark the location of mounting screws.

3.

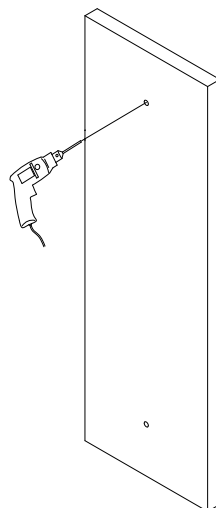

Drill holes in the wall to fit the anchors.

Cooper and Graham always recommends that plumbing products be installed by a licensed professional.

4.

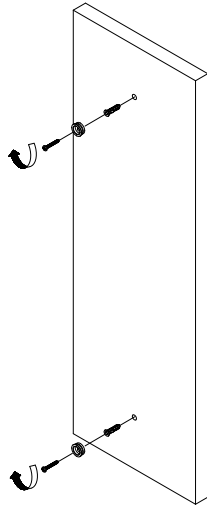

Tap the plastic anchor into the hole with a hammer. Position the mounting bracket to be mounted on the wall, then thread the fixing screws through the mounting hole into the plastic anchor. Turn the screws slowly until they are tight.

5.

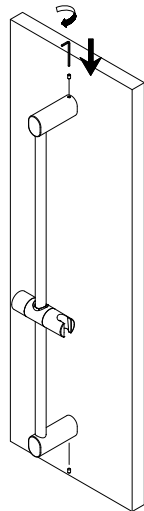

Place assembly over the mounting bracket with the set screws. Tighten the set screws.

INSTALLATION METHOD

Cooper and Graham always recommends that plumbing products be installed by a licensed professional.

Warning (IMPORTANT INFORMATION)

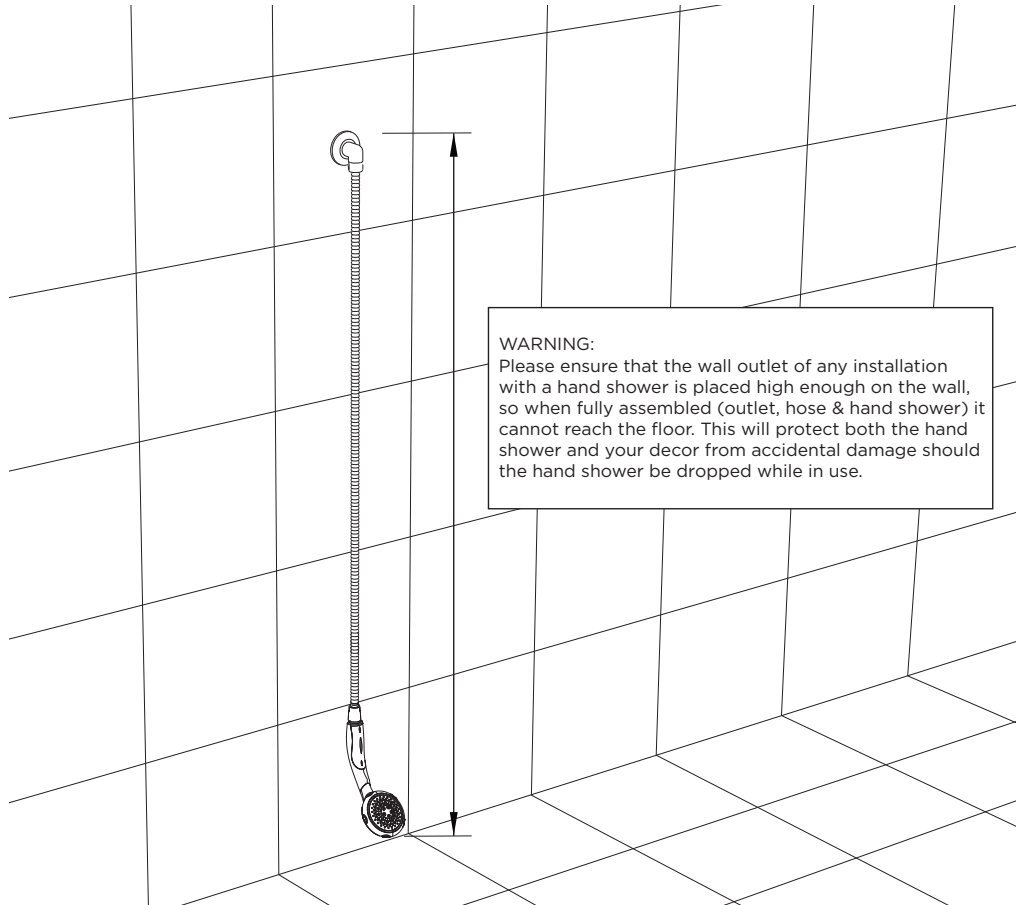

Please ensure that the wall outlet of any installation with a hand shower is placed high enough on the wall, so when fully assembled (outlet, hose & hand shower) it cannot reach the floor. This will protect both the hand shower and your decor from accidental damage should the hand shower be dropped while in use.

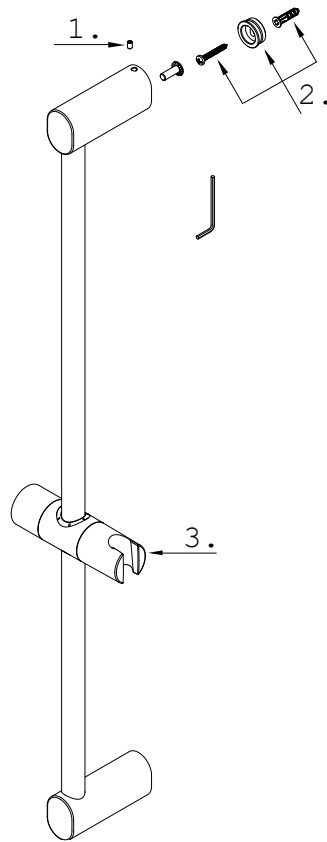

1. Set Screw (A075039)
2. Mounting Hardware (A66G436)
3. Slider Assembly (A555040)

C O O P E R



G R A H A M

FOR ADDITIONAL ASSISTANCE OR SERVICE CALL
T: 929.432.1699 F: 929.432.1833

CUSTOMERSERVICE@COOPERANDGRAHAM.COM
9AM-5PM EST, MONDAY - FRIDAY

COOPER AND GRAHAM

1828 TROUTMAN STREET, RIDGEWOOD, NY, 11385
WWW.COOPERANDGRAHAM.COM